

# THE DISCHARGE OF WASTE WATER FROM AGGLOMERATIONS OF KARÁDI SEWERAGE AND SEWAGE CLEANING

DEAR PROPERTY OWNER,

This is to inform you that implementation of sewage network of **Kötcse** village will be done by the EK Consortium.

The expected start of the implementation work is September 2014.

In order that the place of the connection of sewage conduit can meet your demand, please indicate its place (1 m within the street front boundary of the land with a stick, or on the fencing or pavement with paint) for we can give it accurately on the site, with the technical regulations taken into consideration. For the properties where we cannot find the owner at home and there is no indication in the street front, either, we will perform the connection to the house in the place indicated in the structural drawing.

If you do not stay in the village at the time of implementation, please assign an agent who is allowed to act on your behalf as regards the construction of the connection.

We can perform any construction work in the property only with the consent of the property owner or his agent.

If we cannot get into the property, then we will construct the cleaning eye outside the land boundary in the public area.

Our technicians are ready to help you in the laying out of the place of connection, with the date and time agreed previously.

The on-site contact person from the EK Consortium:

**György Majtényi**  
**8627 Kötcse, Kossuth Lajos Street, 14**  
**Tel.: +36209288801, or +3684368020**  
**E-Mail: majtenyi.gyorgy@gmail.com**  
**Skype: majtenyi.gyorgy**

The sewage conduit is built for you, for the protection of the nature!

We apologize in advance for the traffic restrictions and troubles caused at intervals.

Yours sincerely,

EK Consortium



**SZÉCHENYI** 2020



HUNGARIAN  
GOVERNMENT

European Union  
Cohesion Fund



INVESTING IN YOUR FUTURE

# Sheet of connection to the house (minutes)

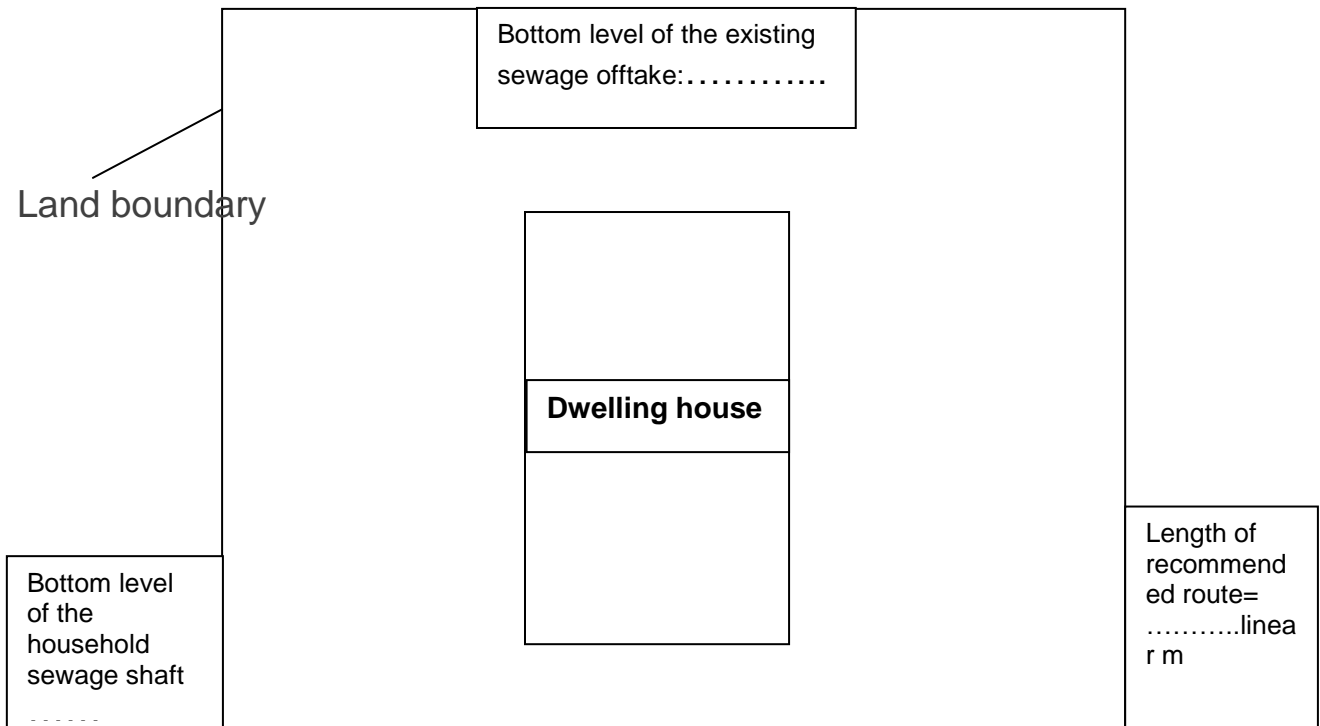

Main pipeline code: .....

..... <b>TOP LOT NO.</b>
<b>Kötcse village..... Street ..... Number</b>

The property owner certifies with his/her signature that the location of the sewage connection was established after technical discussion in accordance with his/her request. Following its construction, any modification deviating from the above will be done by the contractor EK Consortium only on the basis of a separate order, with its costs borne by the Customer.

By signing these minutes, Customer acknowledges that rainwater cannot be connected to the sewage connection since the sewage network is a so-called separated system; its technical parameters do not make it suitable for rainwater drainage. If the operator observes that rainwater is connected to the sewage connection, then it will be closed in the public area until the rainwater connection is terminated.

**We draw the honourable residents' attention that the connection to the sewage network can be performed only and exclusively after the completion of the sewage treatment plant and the conduit system, on the basis of a separate notice!**

Date: Kötcse, ..... (day) ..... (month) 2014

.....  
Property owner's readable name

.....  
Property owner's signature

.....  
Contractor